

Flowseal EPW Wall

A pigmented, water-based epoxy, hygienic wall sealer that is compliant to CSM® (Cleanroom Suitable Materials) requirements.

Suitable for walls in F&B processing plants, pharmaceutical cleanrooms, and hospitals.



Cleanroom Suitable:

Qualified under CSM test parameters for outgassing VOC behaviour.



Hygienic & Easy to Clean:

The seamless finish allows the surface to be cleaned easily.



Low Odour:

Low odour during application for greater client satisfaction.



Breathable:

Vapour permeable and can be applied to damp substrates.



Attractive:

Brightens and enhances the appearance of working environments.



White

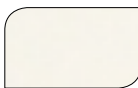

Oyster

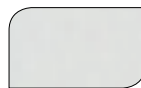

Silver Grey



Dolphin Grey

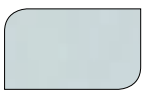

Sky Blue

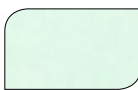

Pale Green

The applied colours may differ from the examples shown.
For a full colour chart and samples, contact your local Flowcrete office.



Technical Profile*

FIRE RESISTANCE

EN 13501-1

B_{fl} - s1

THERMAL RESISTANCE

Tolerant up to 60°C

VAPOUR PERMEABILITY

ASTM: E96:90

20g/m²/mm/24hr

CHEMICAL RESISTANCE

Contact technical department

TVOC (AT 23°C)

ISO 14644-8

ISO-ACC_m Class >-9.6

SPEED OF CURE

10 °C

20 °C

30 °C

Overcoating Time

16 h

8 h

6 h

Full Chemical Cure

14 d

7 d

6 d

Low relative humidity and good ventilation are pre-requisites to achieving the above drying times.

* These figures are typical properties achieved in laboratory tests at 20°C and at 50% Relative Humidity.

Model Specification

System	Flowseal EPW Wall
Finish	Matt
Thickness	0.20mm Dry Film Thickness (3 coats)
Manufacturer	Flowcrete Asia

Preparatory work and application in accordance with manufacturer's instructions.

System Design

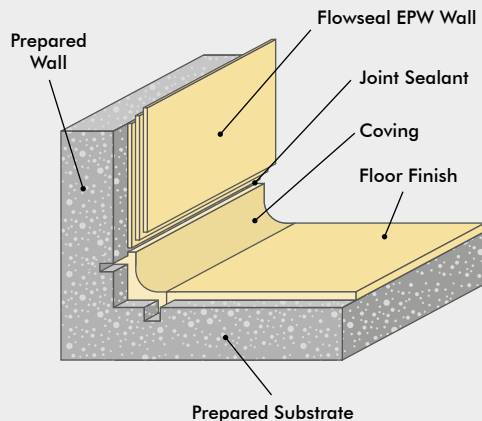

Products Included In This System

Coating	Flowseal EPW Wall
----------------	-------------------

For actual coverage rates, refer to the appropriate project specification.

Detailed application instructions are available upon request.

Substrate Requirements

A smooth, dense substrate such as finishing plasters or similar is recommended to ensure the best finish is achieved.

Installation Service

The installation should be carried out by a licensed contractor with a documented quality assurance scheme. For details of our licensed contractors, contact our customer service team or enquire via our website at www.flowcreteasia.com

Environmental Considerations

The finished system is assessed as non-hazardous to health and the environment. The long service life and seamless surface reduce the need for repairs, maintenance and cleaning. Environmental and health considerations are controlled during manufacture and application of the products by Flowcrete staff and fully trained and experienced contractors.

Important Note

Flowcrete products are guaranteed against defective materials and manufacture and are sold subject to our standard 'Warranty, Terms and Conditions of Sale', copies of which can be obtained on request. Warranty does not cover suitability, fit for purpose or any consequential or related damages.

Further Information

To ensure you are specifying a fit-for-purpose floor, please consult our Technical Advisors or visit our website to register your interest in specifying one of the most durable floors on the market.

1. Light colours may require additional coats to achieve desired results 2. It is recommended that top coat colours are close to base coats colours to achieve desired results
3. This product is not UV stable and may discolour unless otherwise stated 4. System Data Sheet to be read in conjunction with Method Statement and Product data Sheets.