



► Seamless, static control, durable flooring solutions for today's...

DATA CENTRES

www.flowcreteasia.com

WHERE PERFORMANCE

MEETS PROTECTION

FOR DATA CENTRES

Engineered flooring solutions to protect
your data, equipment, and uptime.



Don't Let Static Disrupt Your Data Centre

In data centres, the floor is a vital element that safeguards your sensitive, high-value equipment and ensures optimal operational performance. A major threat to data centre integrity is Electrostatic Discharge (ESD), which is why addressing this critical challenge is essential.

ESD occurs when a static electrical charge suddenly discharges upon contact with a conductive surface. This brief but powerful surge can harm sensitive electronics, causing expensive downtime and data loss. Static generated during routine activities is the cause of ESD events. Common sources include people walking, moving trolleys, plastic items and dry air.

The table below illustrates the typical electrostatic charge (voltage) generated by common activities.

Source	Static voltage
Walking on carpet	Up to 35,000V
Walking on vinyl/ PVC floor	Up to 12,000 V
Worker at workstation	Up to 6,000 V
Safe for electronic devices	<100 V

Damage to modern electronic devices and components is a silent threat. Many sensitive parts can be damaged by electrostatic charges as low as the 100V threshold without anyone noticing.

Why ESD Control Matters?

The solution to preventing ESD is creating a controlled Electrostatic Protected Area (EPA) with Flowcrete's special antistatic resin flooring. This seamless floor quickly and safely dissipates static charges to ground, protecting sensitive equipment and ensuring reliable operations.

Manufactured in ISO-certified plants, Flowcrete's resin floors deliver consistent quality with durable, easy-to-clean, static-control surfaces ideal for data centres.

Flowshield ESD BVG: Next-Generation ESD Protection

Flowshield ESD BVG offers advanced ESD protection using carbon nanotube technology that meets ANSI/ESD S20.20, ASTM F150 Dissipative, and EN 61340-5-1 and EN 61340-4-5. It features a smooth, non-fiber finish and available in light colors. The CSM (clean room suitable material) system supports cleanroom requirements in line with ISO 14644 and contributes to maintaining low VOC levels. This flooring is chemical and wear-resistant and provides a long-lasting, attractive, and safe solution for sensitive electronic environments.



Where To Use Flowcrete Flooring Systems In Your Data Centre (By Floor Zones)

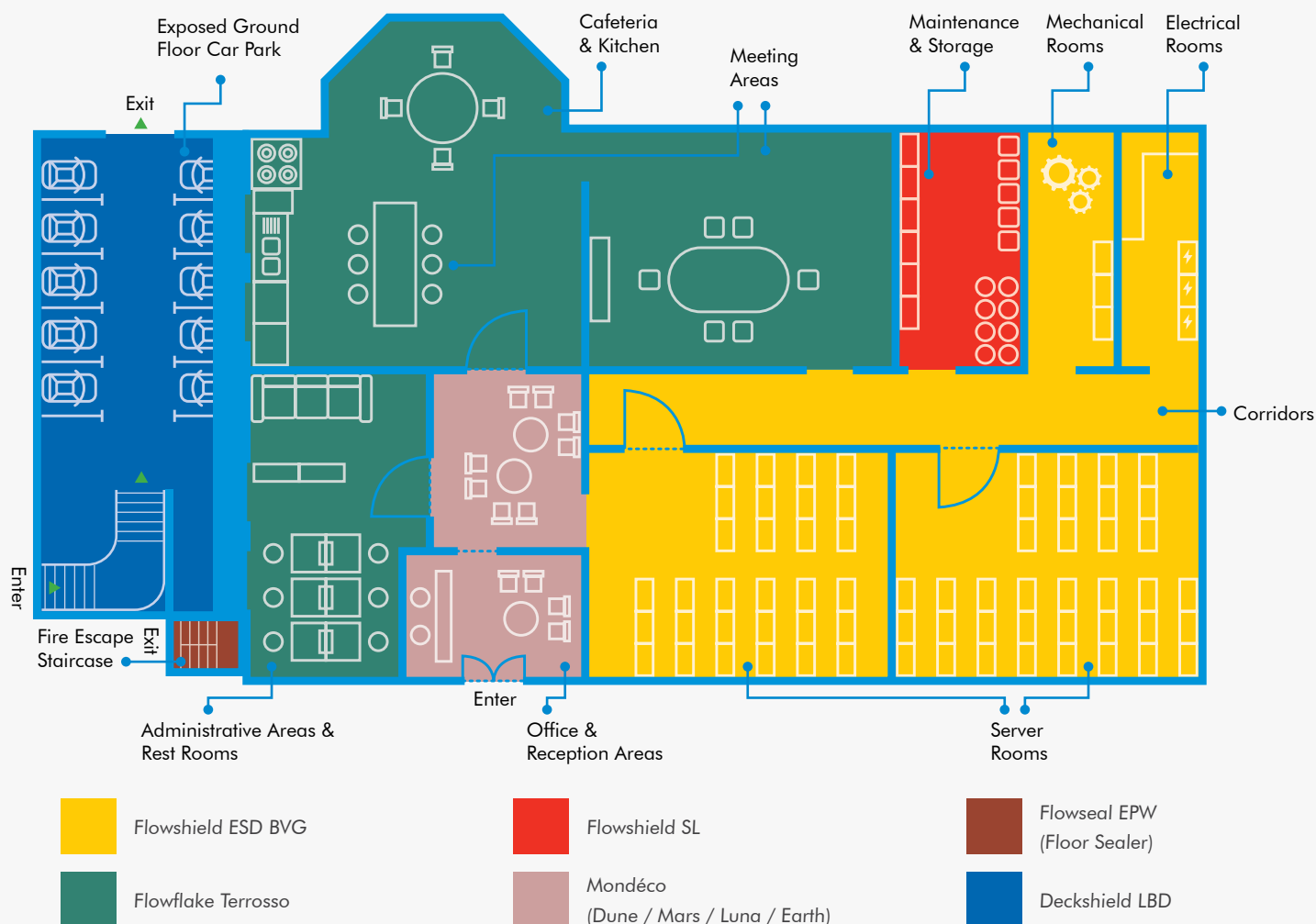

Flowcrete Flooring Systems Summary

	THICKNESS	TYPE	DESCRIPTION
Flowshield ESD BVG	Dependent on specification	Epoxy	An anti-static, self-smoothing epoxy floor coating with carbon nano tube technology that complies with a variety of electrical conductivity requirements.
Flowshield SL	2–3mm	Epoxy	A high-gloss, self-smoothing epoxy floor finish that is compliant with CSM® requirements.
Flowseal EPW (Floor Sealer)	0.20mm Dry Film (3 coats)	Epoxy	A pigmented, water-based, epoxy floor sealer with a satin finish.
Flowflake Terrosso	Dependent on specification	Epoxy	A decorative scattered flakes, epoxy resin terrazzo floor finish.
Mondéco (Dune / Mars / Luna / Earth)	min. 6 mm	Epoxy	A highly decorative, solvent free, epoxy resin terrazzo floor finish.
Deckshield LBD	Dependent on specification	Polyurethane	A technically advanced polyurethane based dissipating moisture barrier traffic coating system

System Design

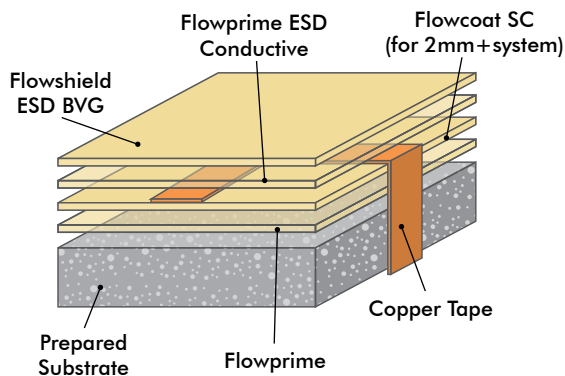

Ivory

Metal Grey

Light Grey

Carbon Grey



Mint Green

Olive Green

**The applied colours may differ slightly from the examples shown above. Contact our customer services for a true colour sample or a special colour match.

Flowshield ESD BVG



A fibre-free antistatic, self-smoothing epoxy floor coating based on nanotechnology, compliant with electrical conductivity requirements.

For use in medium to heavy duty traffic areas where conductive ESD standards are required.



Static Control & Protection.



Meets ANSI/ESD S2020, EN 61340-5-1 and EN 61340-4-5 requirements.



Hard-wearing & abrasion resistant suitable for medium to heavy traffic.

Flowshield SL (2–3mm)



System Design

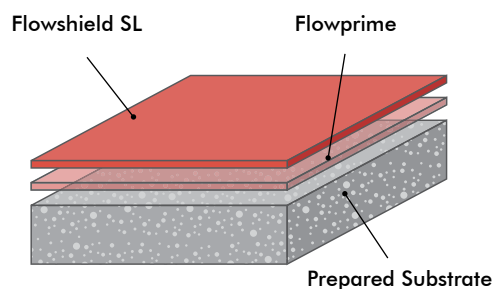

A high-gloss, self-smoothing epoxy floor finish that is compliant with CSM® (Cleanroom Suitable Materials) requirements.

Typical uses include cleanrooms, laboratories, warehouses and storage areas.



Low VOC. Improve indoor air quality.



Hard-wearing & abrasion resistant suitable for medium and heavy traffic environment.



Seamless and high-gloss finish allows the system to be cleaned easily.



Sand

Chilli Red

Steel Blue

Mid Blue



Light Green

Dark Green

Sage Grey

Mist Grey

Steel Grey

**The applied colours may differ slightly from the examples shown above. Contact our customer services for a true colour sample or a special colour match.

System Design

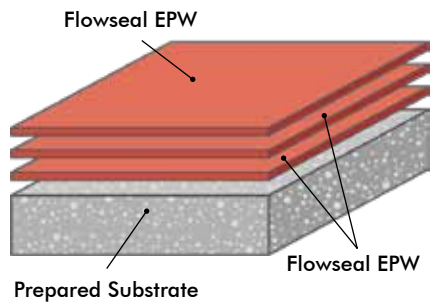

**The applied colours may differ slightly from the examples shown above. Contact our customer services for a true colour sample or a special colour match.

Flowseal EPW

(Floor Sealer)

A pigmented, water-based, epoxy floor sealer with a satin finish that provides a seamless, easy to clean, non-dusting environment.

Suitable for light industrial areas, storerooms and areas of pedestrian traffic.



The seamless finish allows the system to be cleaned easily.



Solvent free, low in VOCs and environmentally friendly.



Vapour permeable and can be applied to damp substrates.

Flowflake Terroso



An epoxy resin floor finish that contains varying sizes of flakes scattered over a pigmented base coat and finished with a clear sealer.

Ideal for use in commercial settings such as retail showrooms, designer outlets and offices.



A decorative floor finish that is available in a range of colour combinations.



Speckled flake finish disguises visible surface scratches.



The seamless finish allows the system to be easily cleaned.

System Design

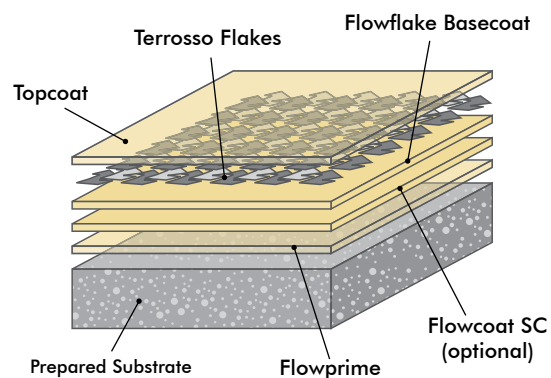

Black Granite



Glacier



Seashell



Frosty



Grey Granite



Moonlite



Oyster



Storm

**The applied colours may differ slightly from the examples shown above. Contact our customer services for a true colour sample or a special colour match.

System Design

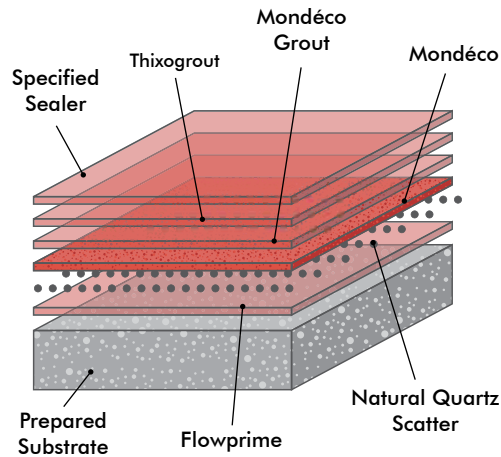

Mondéco

(Dune / Mars / Luna / Earth)

A highly decorative, solvent free, epoxy resin terrazzo floor finish which incorporates granite, marble or flint aggregates.

Suitable for public areas where high end aesthetics and durability are of key concern.

Mondéco Dune



Mondéco Mars

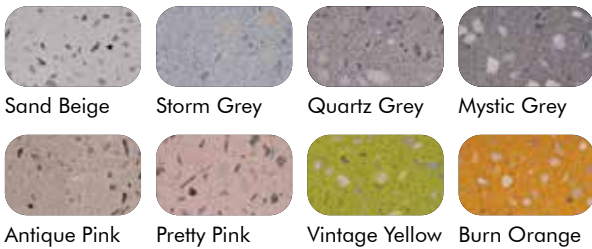

Mondéco Luna

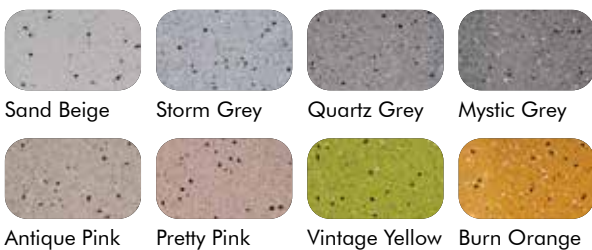

Mondéco Earth

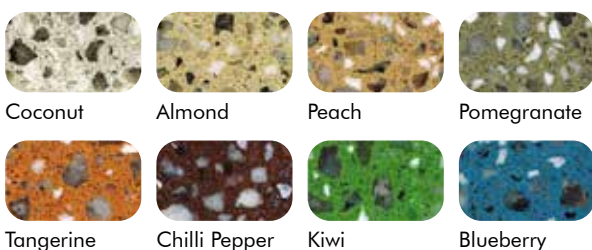

**The applied colours may differ slightly from the examples shown above. Contact our customer services for a true colour sample or a special colour match.



A decorative, speckled floor finish that is available in a range of colours.



Colours & patterns can be tailored to meet the clients design requirements.



Solvent free, low in VOCs and environmentally friendly.



System Design

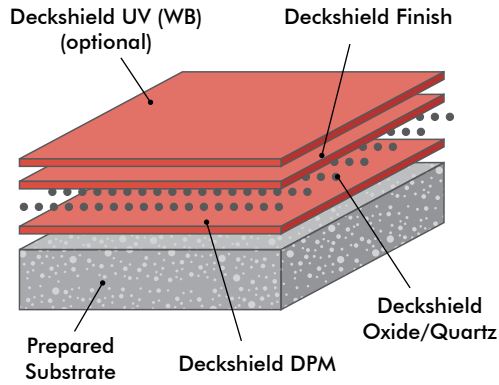

**The applied colours may differ slightly from the examples shown above. Contact our customer services for a true colour sample or a special colour match.

Deckshield LBD

Deckshield LBD is a polyurethane traffic coating system that incorporates a technically advanced polyurethane based dissipating moisture barrier.

Ensures the controlled dissipation of moisture vapour at the lowest basement car park levels.



Slip-resistant & safe surface.



Attractive & clearly marked Finish.



Durable & long-lasting.

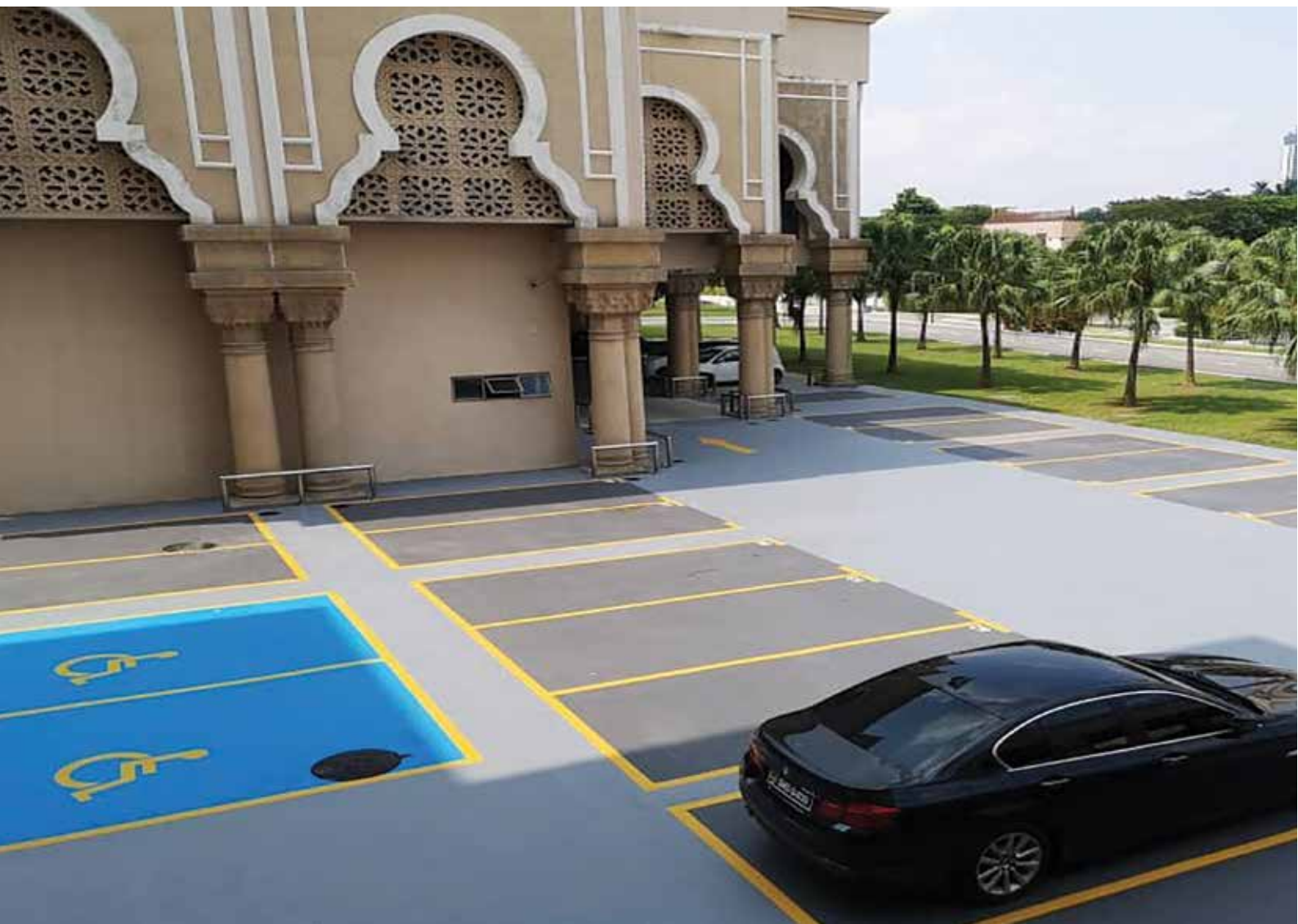

TRUSTED BY LEADING BRANDS

amazon

Keppel

Microsoft

Princeton Digital Group

SingTel

VANTAGE
DATA CENTERS



Flowshield ESD BVG
Antistatic



Flowshield SL
Cleanroom Suitable Materials



Flowseal EPW
Seamless Finish



Flowflake Terrosso
Easy Clean



Deckshield LBD
Antislip



Mondéco
Decorative

Flooring
Solutions for
EVERY space
and function

OUR COMMITMENT TO EXCELLENCE

At Flowcrete, we take pride in delivering flooring solutions that meet and exceed the highest international standards for quality, performance, safety, and sustainability. Every product is the result of our dedication to innovation, precision, and environmental responsibility.

Certifications & Standards:

- ISO 9001:2015 – Certified Quality Management System
- ISO 14001:2015 – Environmental Management System
- ISO 45001: 2018 - Occupational Health and Safety Management Systems
- ANSI/ESD S20.20, EN 61340-5-1 and EN 61340-4-5 – Performance tested for ESD flooring
- CSM – Certified Cleanroom Suitable Materials
- VOC Compliant / Singapore Green Building Product certified – Low-emission, environmentally responsible products



Trusted Worldwide • Certified for Quality • Committed to Sustainability



Australia | China | Hong Kong | Indonesia | Japan | Macao | Malaysia | New Zealand
Philippines | Singapore | South Korea | Taiwan | Thailand | Vietnam



www.flowcreteasia.com



asia@flowcrete.com



Contact Us

*Whilst every care has been taken to ensure that the information included in this document was accurate at the time of printing, the publisher of this document reserves the right to change product specifications at any time without prior notice. The photographs and colours reproduced in this publication are within the constraints of the printing process and are not to be used for matching purposes. All photographs are used for approximate representation only and may not show the actual products on offer. E&OE.